

GAE - CYLINDRICAL FUSE



3b

APPLICATIONS

Protection against overload and short circuit in electric lines (Type gG).

Rated voltage up to 660 V; Rated current up to 32 A; working frequency 50 Hz AC; Rated breaking capacity up to 100 KA. Compliant with GB13539 and IEC269.

Basic Data

The models, dimension, ratings are shown in figure

Characteristics Curve

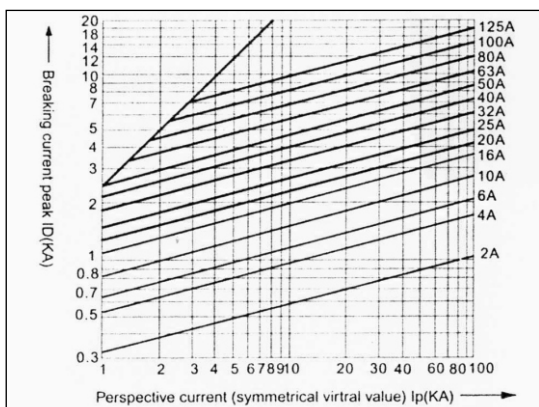

Time-Current Range of "gG" Fuse Links

DESIGN FEATURES

Variable cross-section fuse element made from pure metal sealed in cartridge made from high-duty ceramic or epoxy glass.

Fuse tube filled with chemically treated high-purity quartz sand as arc-extinguishing medium. Dot-welding of fuse element ends to the caps ensures reliable electric connection; Striker may be attached to the fuse link to provide immediate activation of micro switch to give various signals or cut the circuit automatically.

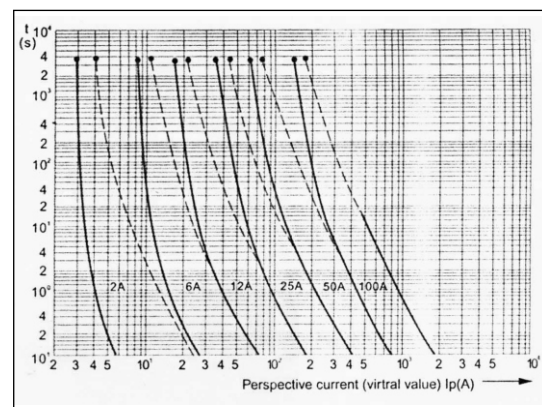

Breaking Current Characteristics Curve of "gG" Fuse Links

Cylindrical Fuse

FUSE PROTECTION GAE - Cylindrical Fuse

- Rated Voltage : 380/500 V
- Rated Breaking Capacity : up to 100 kA
- C l a s s : gI - gL - gG
- Material of Insulator : High-duty Ceramic

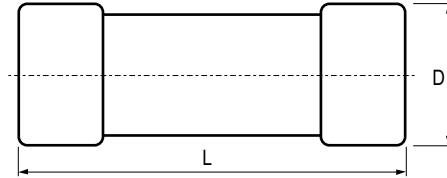

Size	Ampere	Code no.	Packing pcs
0 (D x L) 10.3 x 38	4	240202112	10
	6	240202118	10
	8	240202124	10
	10	240202130	10
	12	240202136	10
	16	240202142	10
	20	240202148	10
	25	240202154	10
	32	240202160	10

3b

GAE - CYLINDRICAL FUSE BASE



3b

APPLICATIONS

These fuse holders are supporters for fuses with size 10.3 x 38. They are capable of working under heat caused by rated current and expected short impacting current up to 100KA. It can also function as a fuse disconnecting switch by multi-phase combination.

Rated insulate voltage up to 500 V; Working frequency 50Hz AC; Conventional free air thermal current 32A; Compliant with GB13539.1, GB13539.2, GB13539.6, GB14048.3 and IEC269-1, IEC269-2, IEC269-2-1, IEC947-3.

DESIGN FEATURES

After the plastic-injected case is equipped with contacts and fuse links, the bases are formed by welding or riveting both capable of being multi-phase structured.

One is installed with fuse links of the according size. The other is a permanent open contacts with double breaking points. The whole base unit can cut the power. RT18 bases are all DIN rail installed.

GAE - Cylindrical Fuse Base

- Material of Base : Plastic
- Installed : DIN rail

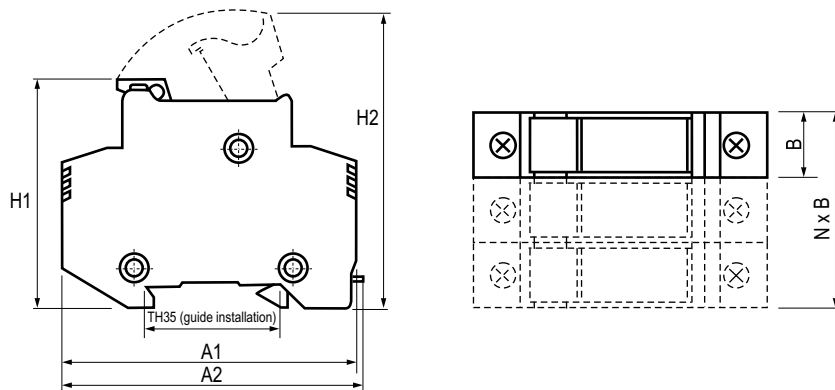

Size	Ampere	Pole	A1	A2	B	H1	H2	Packing pcs	Weight (kg)	Code Nr.
RT18 (10.3 X 38) without LED	32 A	1 pole	79	81	18	61	80	1	0.59	230501012
RT18 (10.3 X 38) with LED	32 A	1 pole	79	81	18	61	80	1	0.59	230501013
RT18 (10.3 X 38) with LED	32 A	3 pole	79	81	54	61	80	1	1.77	230501018